

X
KRUX

GLOW
KRX0008

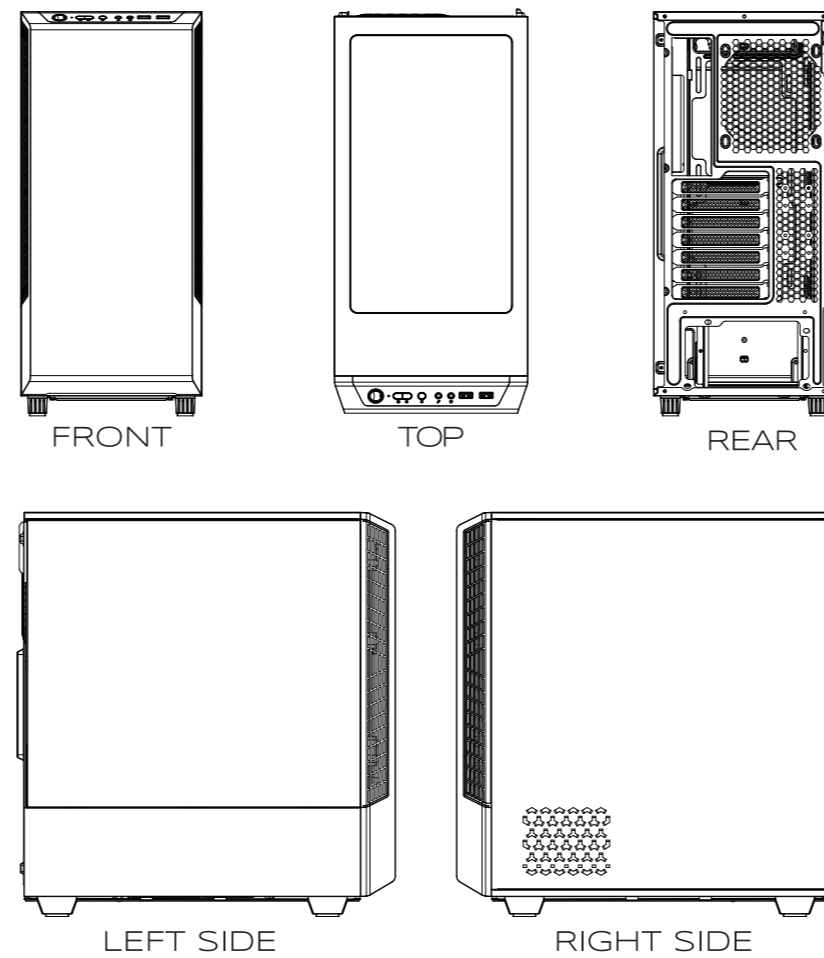

- 1 - CHASSIS MAIN BODY
- 2 - LEFT TEMPERED GLASS SIDE PANEL
- 3 - RIGHT SIDE PANEL
- 4 - POWER SUPPLY BOX
- 5 - DUST-PROOF FILTER AT BOTTOM PANEL
- 6 - DUST-PROOF FILTER AT TOP PANEL
- 7 - SSD BRACKET
- 8 - CABLE MANAGEMENT BOX
- 9 - RGB CONTROL BOARD BOX
- 10 - HDD BRACKET
- 11 - VGA CARD BRACKET
- 12 - VGA CARD INSTALLATION POSITION
- 13 - REAR FAN INSTALLATION POSITION
- 14 - FRONT FAN INSTALLATION POSITION

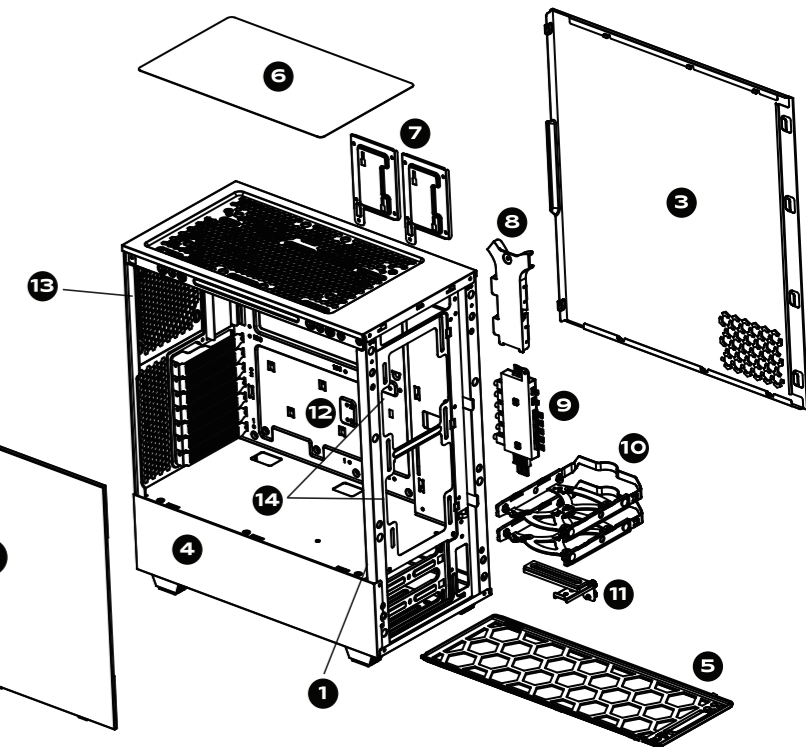

I/O PORTS INTRODUCTION

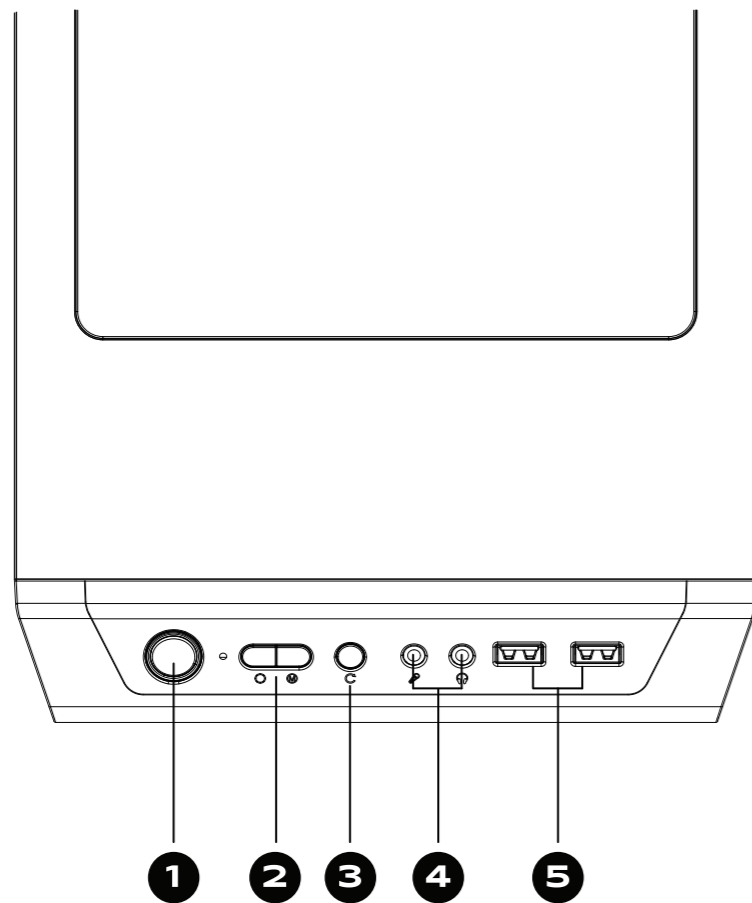

- 1 - POWER SWITCH
- 2 - REG LED LIGHT CONTROL
- 3 - RESET BUTTON
- 4 - MIC, HEADPHONE
- 5 - USB PORT

SIDE PANEL INSTALLATION INSTRUCTION

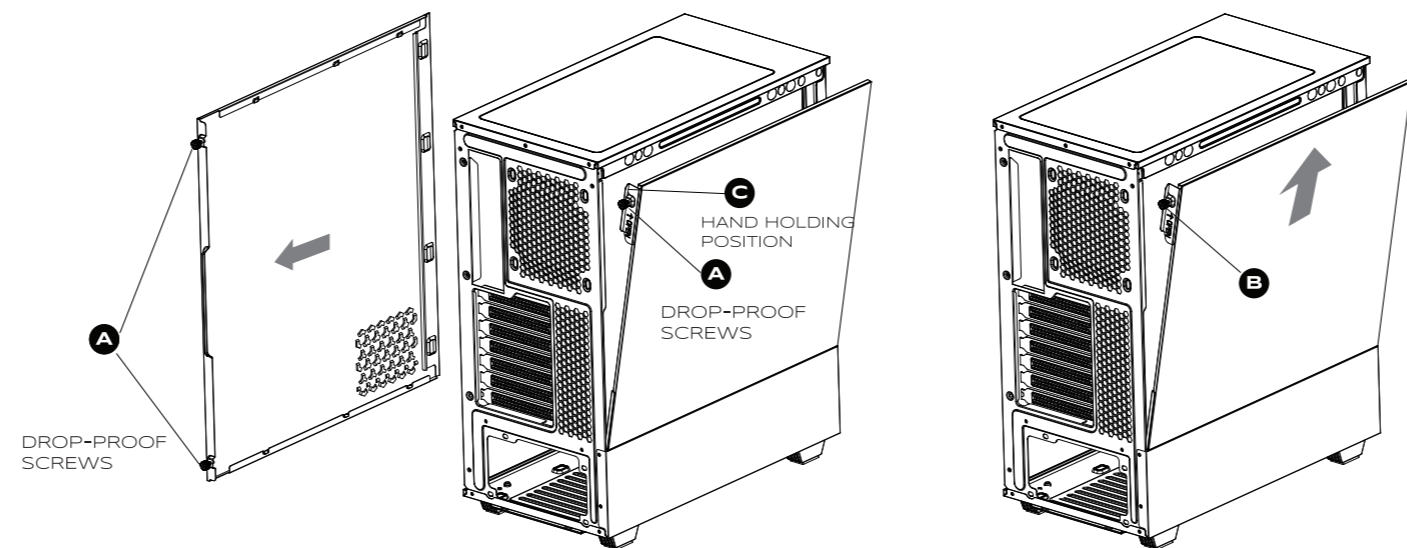

1. LOOSE THE DROP-PROOF SCREWS A, PULL OUT THE RIGHT SIDE PANEL TOWARD TO THE ARROWHEAD DIRECTION.

2. LOOSE THE DROP-PROOF SCREWS A, HOLD THE HAND-HOLDING POSITION THEN PULL OUT THE SIDE PANEL TO THE ANGLE AS PICTURE TWO THEN PULL UP THE SIDE PANEL AS THE ARROWHEAD DIRECTION.

POWER SUPPLY INSTALLATION

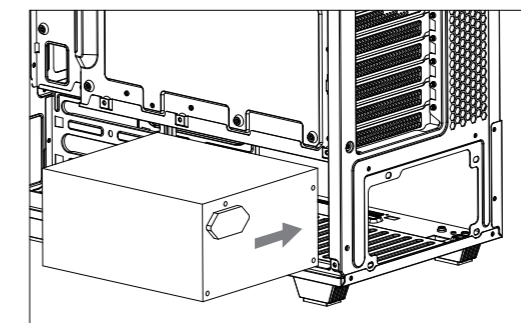

1. REMOVE RIGHT SIDE PANEL, THEN PUT INTO THE PSU ACCORDING TO THE ARROW-HEAD DIRECTION.

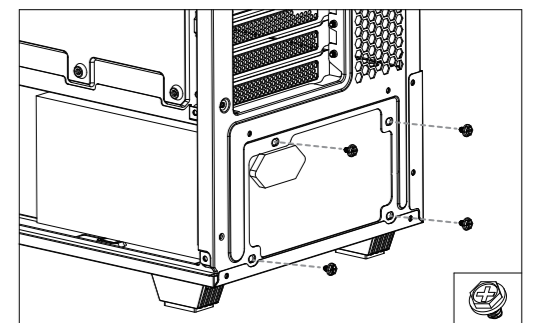

2. FIX THE SCREWS.

POWER SUPPLY INSTALLATION

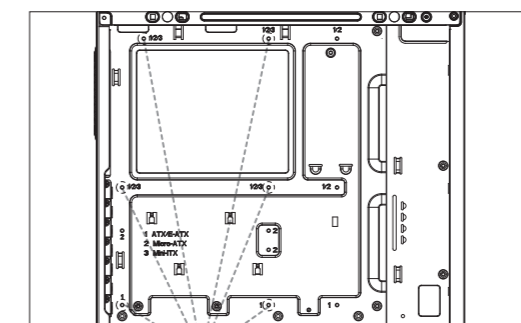

PRE-INSTALLED 6 MOTHERBOARD SCREWS IN FACTORY SETTING.

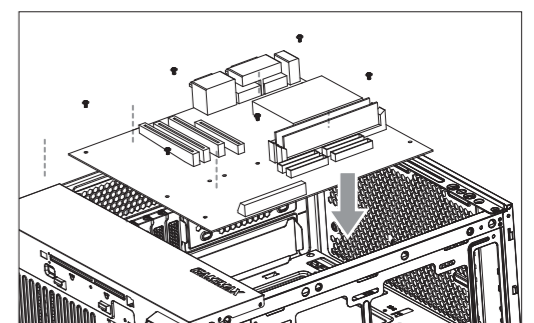

PUT THE MOTHERBOARD INTO THE RIGHT POSITION ACCORDING TO THE ARROWHEAD DIRECTION, THEN FIX THE SCREWS.

HDD INSTALLATION

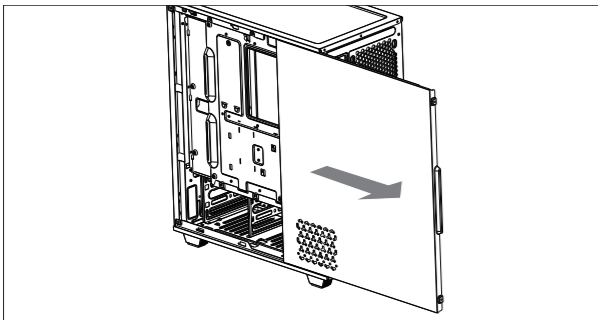

REMOVE THE RIGHT PANEL, HOLD THE PANEL LIKE IN THE PICTURES, THEN PULL THE RIGHT PANEL.

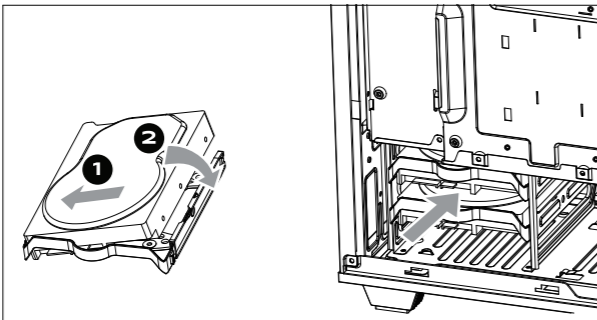

FIX THE HDD INTO THE HDD TOOL-LESS BRACKET ACCORDING TO THE STEP 1 2 THEN PUT INSIDE THE HDD BRACKET INTO THE HDD SLOTS ACCORDING TO ARROWHEAD DIRECTION.

SSD INSTALLATION

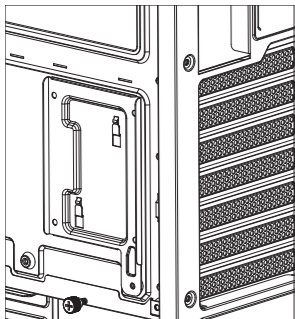

1. REMOVE THE SCREWS AND TAKE OFF THE SSD BRACKET.

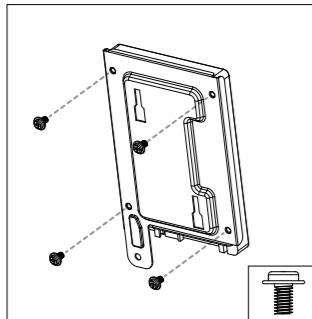

2. ASSEMBLY THE SSD AND FIX THE SCREWS.

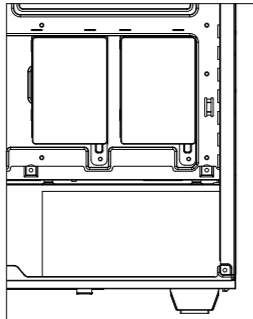

3. INSTALL THE SSD IN THE CHASSIS NEAR THE TOP AND LEFT EDGE OF THE M/B BRACKET AND PUT INTO THE RIGHT POSITION.

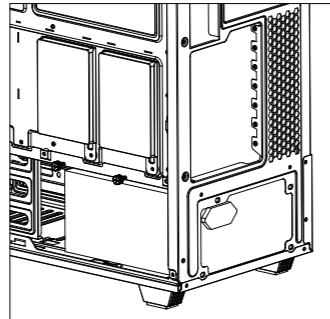

4. FIX THE SCREWS AND FINISH INSTALLATION.

DISASSEMBLY FOR DUST-PROOF FILTERS

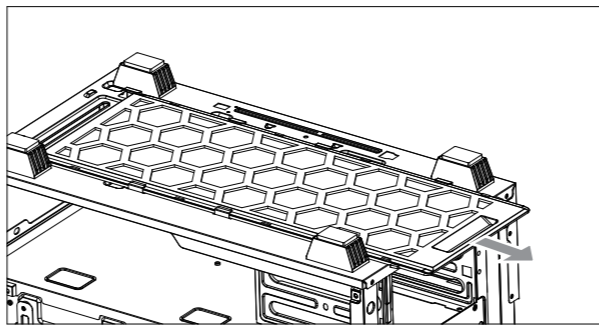

PULL OUT THE DUST -PROOF FILTER ACCRODNING TO THE ARROWHEAD DIRECTION.

VGA CARD HOLDER INSTALLATION

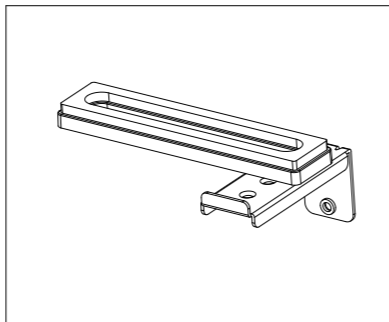

1. VGA CARD HOLDER

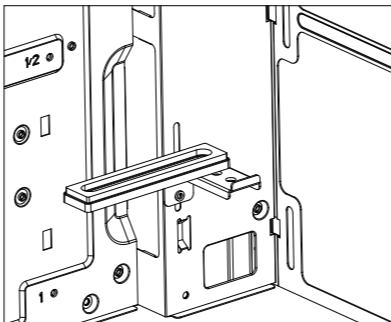

2. PUT THE HOLDER INTO THE SUITABLE POSITION ON THE MOTHERBOARD PLATE ACCORD- ING TO THE VGA.

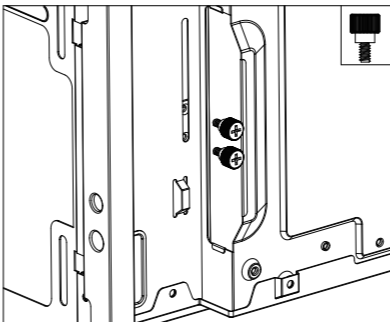

3. FIX THE SCREWS AT THE REAR SIDE OF THE MOTHERBOARD PLATE.

MOVE THE VGA CARD HOLDER

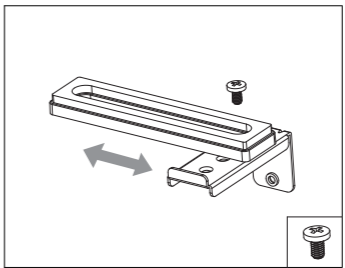

1. LOOSE THE HANDY SCREWS, MOVE THE HOLDER TO THE SUITABLE POSITION TOWARDS THE ARROWHEAD DIRECTION ACCORDING TO THE VGA CARD LENGHT, THEN FIX IT.

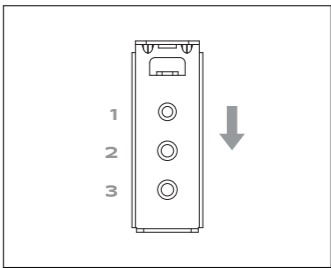

2. MOVE THE HOLDER TOWARDS THE ARROWHEAD DIRECTION ACCORDING TO THE VGA CARD WIDTH, THEN FIX IT IN PLACE.

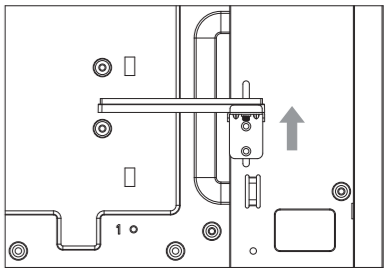

3. MOVE THE HOLDER TOWARDS THE ARROWHEAD DIRECTION ACCORDING TO THE VGA CARD THICKNESS, THEN FIX IT IN PLACE.

MOVE THE VGA CARD HOLDER

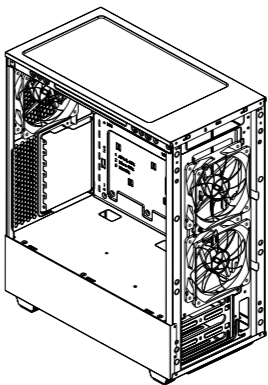

FAN SUPPORT:
FRONT: 2X 120 MM OR 2X 140MM
TOP: 2X 120 MM OR 2X 140 MM
REAR: 1X 120 MM

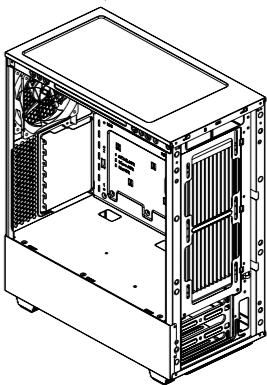

LIQUID COOLING SUPPORT:
FRONT: 120/140/240/280 MM
TOP: 120/140/240/280 MM
REAR: 120 MM

GLASS SIDE PANEL INSTALLATION

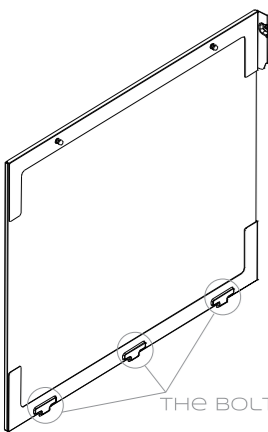

1. FIND THE BOLT ON THE GLASS PANEL.

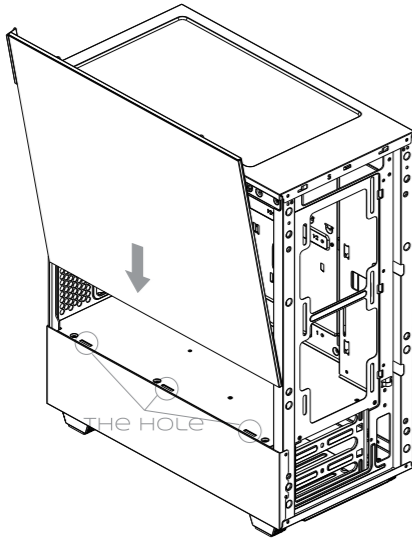

2. ALIGN THE BOLT INTO THE HOLE, THEN INSERT.

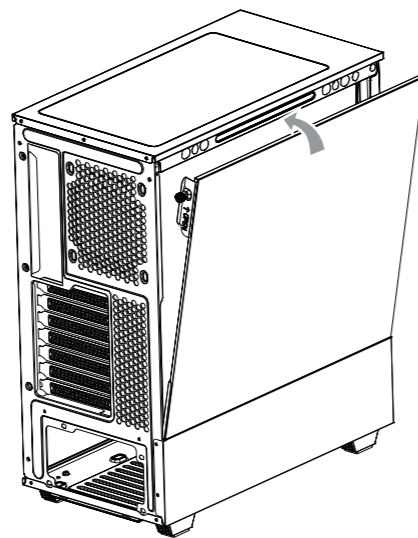

3. INSTALL THE GLASS PANEL AS IN THE PICTURE AND FIX THE SCREW.

WWW.KRUX.TECH